

3945

**Marysville
Boulevard**

**Dental Office Building
Sacramento, CA**

For Sale Dental Office Building
Owner/User or Investment Opportunity



Marysville
Boulevard



2131 CAPITOL AVE, STE 100
SACRAMENTO, CA 95816
916.573.3300 | [TURTONCOM.COM](https://www.turtoncom.com)

SCOTT KINGSTON
SENIOR VICE PRESIDENT - LIC. 01485640
916.573.3309
SCOTTKINGSTON@TURTONCOM.COM

© 2024 This information has been secured from sources believed to be reliable. Any projections, opinions, assumptions or estimates used are for example only and do not constitute any warranty or representation as to the accuracy of the information. All information should be verified through an independent investigation by the recipient, prior to execution of legal documents or purchase, to determine the suitability of the property for their needs. Logos and/or pictures are displayed for visual purposes only and are the property of their respective owners.



THE OPPORTUNITY

± 8,067

RSF

\$3,050,000

PURCHASE PRICE

TURN-KEY

DENTAL OFFICE

6.5 YEARS

LEASE REMAINING

TURN-KEY DENTAL BUILDING OWNER/USER OR INVESTMENT OPPORTUNITY IN NATOMAS

This remarkable investment opportunity in Sacramento, CA, presents a perfect scenario for both investors and established dentists seeking a future home for their practice. This turn-key dental building boasts a spacious 8,067 square feet and offers a secure investment with a ± 6.5-year lease already in place, that could be made available immediately upon close to an owner/user.

GUARANTEED RETURN ON INVESTMENT:

- **Stable Income Stream:** Enjoy a consistent and reliable income stream throughout the lease term, with a well-established tenant already occupying the space.
- **Prime Location Advantage:** Natomas' growing population ensures continued demand for dental services, making this a sound long-term investment.

OWN AND OCCUPY OPPORTUNITY:

- **Future Flexibility:** As the lease nears its end, capitalize on the chance to seamlessly transition the space into your dream dental practice, eliminating the need for construction or build-out delays.
- **Own Your Space:** Invest in your future by owning the building you operate from. This not only fosters stability but also offers potential tax benefits and equity-building opportunities.

MOVE-IN READY CONVENIENCE:

- **Turn-Key Design:** The meticulously designed space features modern dental infrastructure, ready to accommodate a variety of dental practices.
- **Minimize Disruption:** Existing tenants often maintain the property well, ensuring a smooth transition for future owner-occupants.



BEYOND THE BUILDING:

- **Natomas' Charm:** This desirable Sacramento suburb offers a thriving community and a family-friendly atmosphere, ideal for attracting patients.
- **Accessibility and Growth:** The Property's convenient location ensures easy patient access, with ample parking available. Natomas' continued growth potential bodes well for future value appreciation.

This turn-key dental building presents a unique opportunity to secure a stable investment or lay the foundation for your future dental practice or as a perfect long term investment for your real estate portfolio.

Note: The current tenant, Western Dental, has an expiring lease, with no options 12/31/2030, and may be open to a lease termination in advance of that for an owner/user.

PROPERTY DETAILS

Address:	3945 Marysville Blvd, Sacramento, CA 95838
APN:	251-0044-002
County:	Sacramento County
Purchase Price:	\$3,050,000
Capitalization Rate:	5.5%
Building Size:	± 8,067 SF
Building Type:	Medical / Dental Building
Stories:	One (1)
Parcel Size:	± 18,731 SF
Year built:	1947
Zoning:	C-2
Current Lease Expiration:	12/31/2030
Options to Renew:	None

Notes: The current tenant, Western Dental, has an expiring lease, with no options 12/31/2030, and may be open to a lease termination in advance of that for an owner/user.



SITE PLAN

FLOOR PLAN

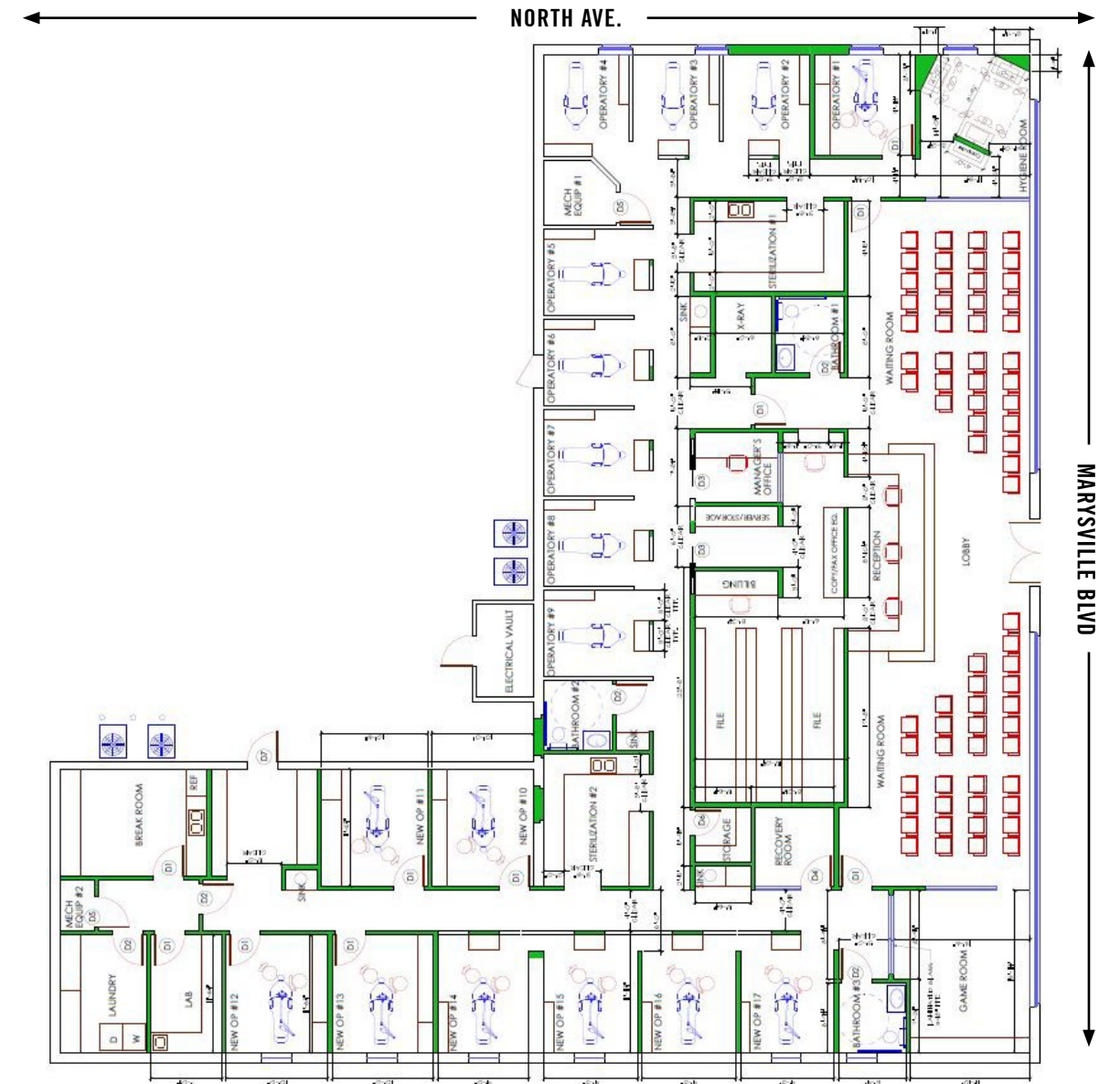
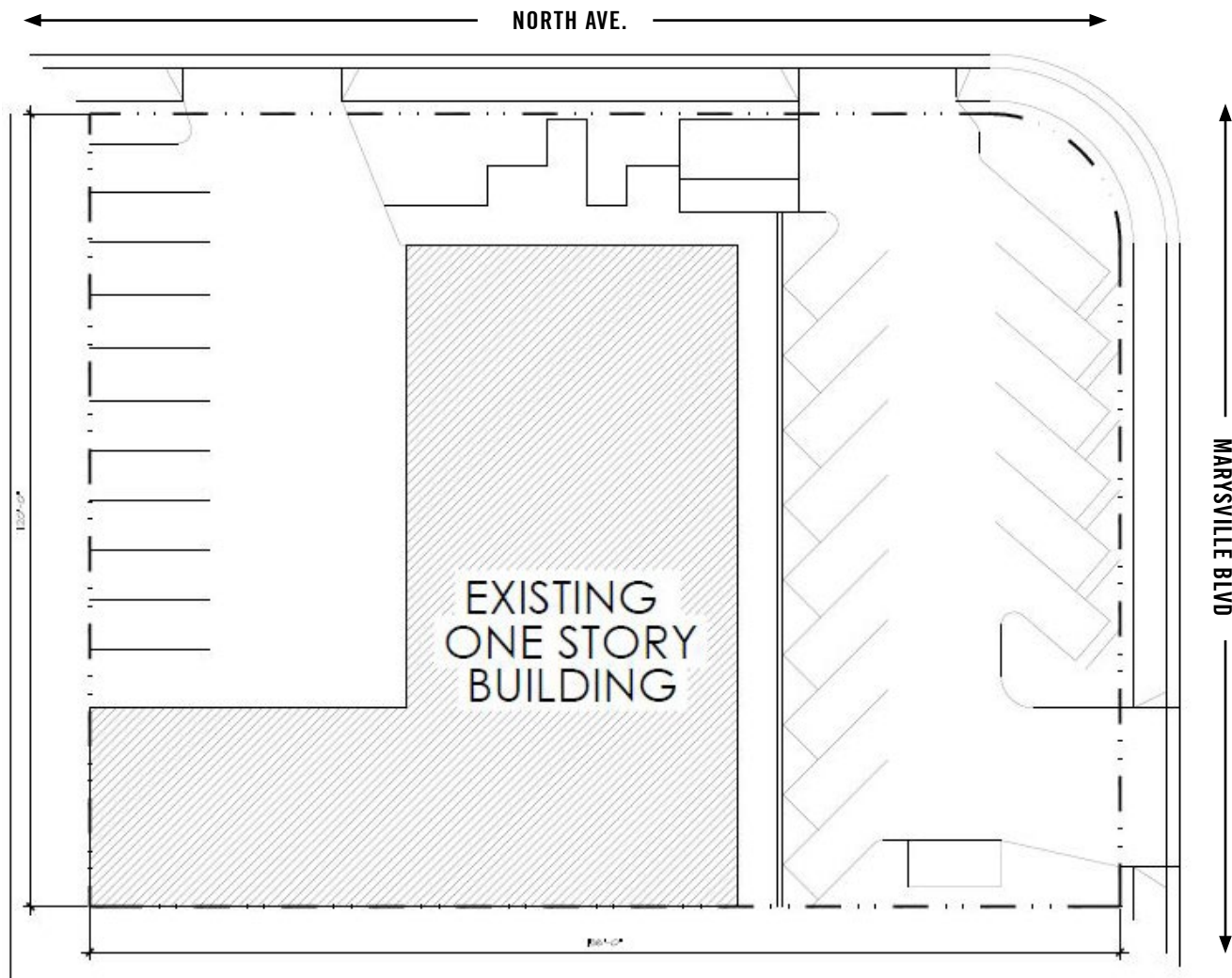

ECONOMICS

REVENUE

Suite	Tenant	Size	Expiration	Base Rent Per Mo	Base Rent Per Year MG
108-110	Western Dental	8,067	12/31/30	\$16,140.35	\$193,684.20
	Base Year Passthrough			\$1,961.94	\$23,543.24
Subtotal		8,067		\$18,102.29	\$217,227.44

EXPENSES

Item	Per Month	Per Year
Transaction Fee	\$0.00	\$0.00
Business Tax	\$0.00	\$0.00
CAM Expense	\$0.00	\$0.00
Insurance Expense	\$179.36	\$2,152.27
Janitorial Expense	\$73.33	\$880.00
Landscaping & Groundkeeping	\$308.33	\$3,700.00
License & Permit Fee	\$8.26	\$99.16
Repairs & Maintenance	\$385.63	\$4,627.50
Taxes - Property	\$3,052.98	\$36,635.71 *
Subtotal	\$4,007.89	\$48,094.64
Net Operating Income		\$169,132.80

* Note: based on disposition price of \$3,050,000





NATOMAS

THRIVE IN NATOMAS: A COMMUNITY WHERE DENTISTRY FLOURISHES

Sacramento's dynamic Natomas region offers a fertile ground to cultivate a thriving dental practice. This fast-growing community presents an exceptional opportunity to cater to a diverse and expanding patient base.

Owning a dental practice in Natomas positions you at the heart of a flourishing community. This strategic location, coupled with the building's features, presents a remarkable opportunity to establish a successful and enduring dental practice.

POPULAR RESTAURANTS & AMENITIES NEAR 3945 MARYSVILLE BLVD (NOT ALL ARE MENTIONED HERE):

AutoZone Auto Parts	El Pollo Loco	Hagginwood Elementary	Lucky Express	Robla Community Park
Cap City Creations	El Senor del Monte Taco	Haggin Oaks Golf Complex	Luna's Flame & Grill	Smart & Final Extra!
Castori Park	Fiji Mart	Hooten Tire Co	Michael J. Castori Elementary	Taylor Street Park
Connie's Drive-In	Foods Co	Jimboy's Tacos	Pothong Market	Tori's Place
dd's DISCOUNTS	Futures High School	Jimmy's Deli Soul Food	Pupusas Central	USPS
Del Paso Country Club	Grant Union High School	Keema School	Q & R BBQ	Valley Tire & Wheel
Dollar General	Grant West High School	Las Nenas Taqueria	Rainbow Market	Viva Supermarket

A COMMUNITY ON THE RISE:

- **Explosive Growth:** Natomas is one of the fastest-growing areas in Sacramento, attracting young families and professionals. This translates to a constant influx of new patients seeking dental services.
- **Family-Oriented Focus:** With numerous schools and a family-friendly atmosphere, Natomas presents a lucrative market for pediatric dentistry, orthodontics, and general dentistry services.

STRATEGIC ADVANTAGES:

- **Central Hub:** Natomas boasts a central location within Sacramento, offering convenient access to patients from all corners of the city.
- **Excellent Infrastructure:** The area features a well-developed network of roads and highways, ensuring easy patient commutes and ample parking options near the property.

BEYOND DEMOGRAPHICS:

- **Active Lifestyle:** Natomas residents enjoy a vibrant lifestyle, with access to parks, trails, and outdoor recreation facilities. This focus on health and wellness fosters a strong demand for preventative dental care.
- **Economic Powerhouse:** Natomas is home to a booming business sector, attracting professionals with disposable income and a focus on maintaining good oral health.

Marysville
Boulevard



2131 CAPITOL AVE, STE 100
SACRAMENTO, CA 95816
916.573.3300 | [TURTONCOM.COM](https://www.turtoncom.com)

SCOTT KINGSTON
SENIOR VICE PRESIDENT - LIC. 01485640
916.573.3309
SCOTTKINGSTON@TURTONCOM.COM

© 2024 This information has been secured from sources believed to be reliable. Any projections, opinions, assumptions or estimates used are for example only and do not constitute any warranty or representation as to the accuracy of the information. All information should be verified through an independent investigation by the recipient, prior to execution of legal documents or purchase, to determine the suitability of the property for their needs. Logos and/or pictures are displayed for visual purposes only and are the property of their respective owners.



TURTON
COMMERCIAL REAL ESTATE